

# TIMELINE 50 BUILT-IN SINK RECTANGLE

## PRODUCT INFORMATION

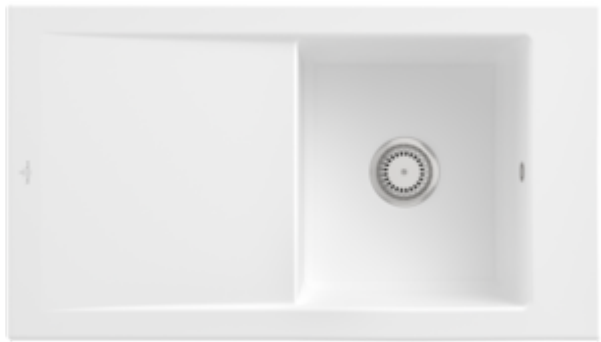

Article title	Villeroy & Boch Timeline 50 Built-in sink, included Waste system hand-operated, of Ceramic, 900 x 510 mm, Stone White CeramicPlus
Article number	330701RW
Assembly / Assembly type	surface-mounted installation
Assembly instructions	minimum unit width: 50 cm
Scope of delivery	1 x sink , 1 x basket strainer waste
Length in mm	510
Width in mm	900
Height in mm	220
Interior depth	200
Collection	Timeline 50
Material	Ceramic
Colour name	Stone White CeramicPlus
Other material	Grate: Stainless steel Valve: Stainless steel
Position of main bowl	Basin, reversible
Function of the drain fitting	basket strainer waste
Colour designation	Stone White
Other colour designations	Grate: Chrome, Valve: Chrome

## TECHNICAL DRAWINGS

**330701RW**

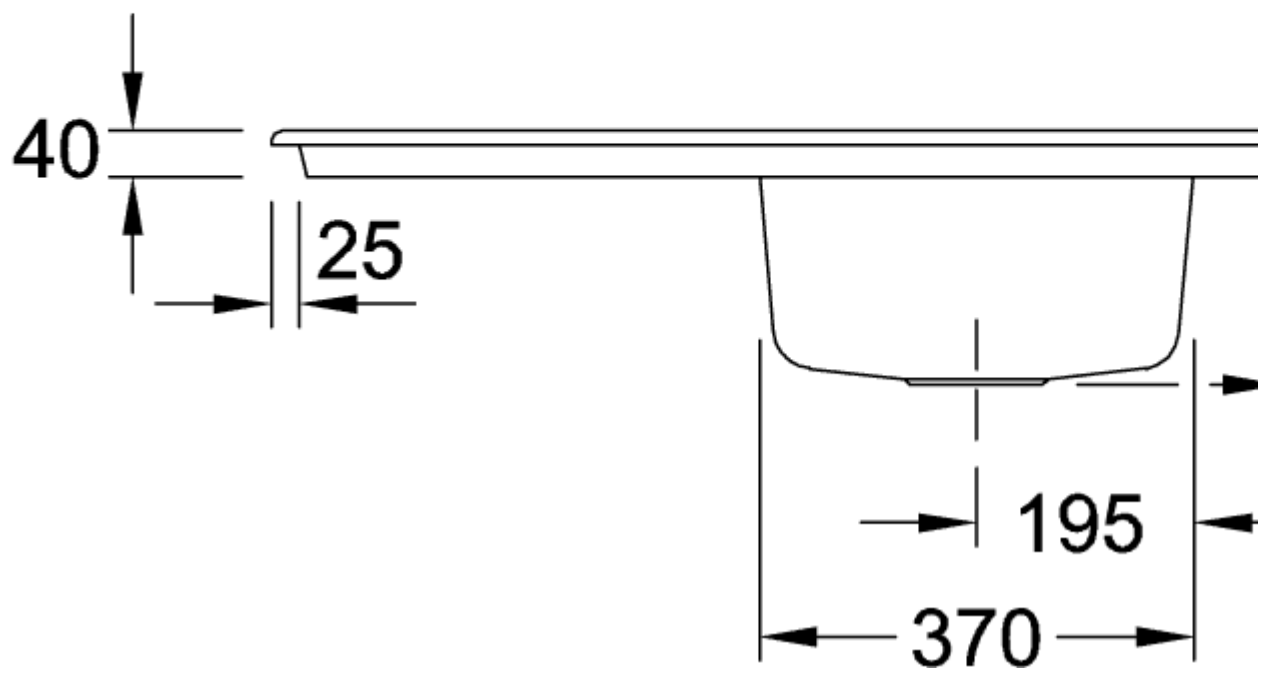
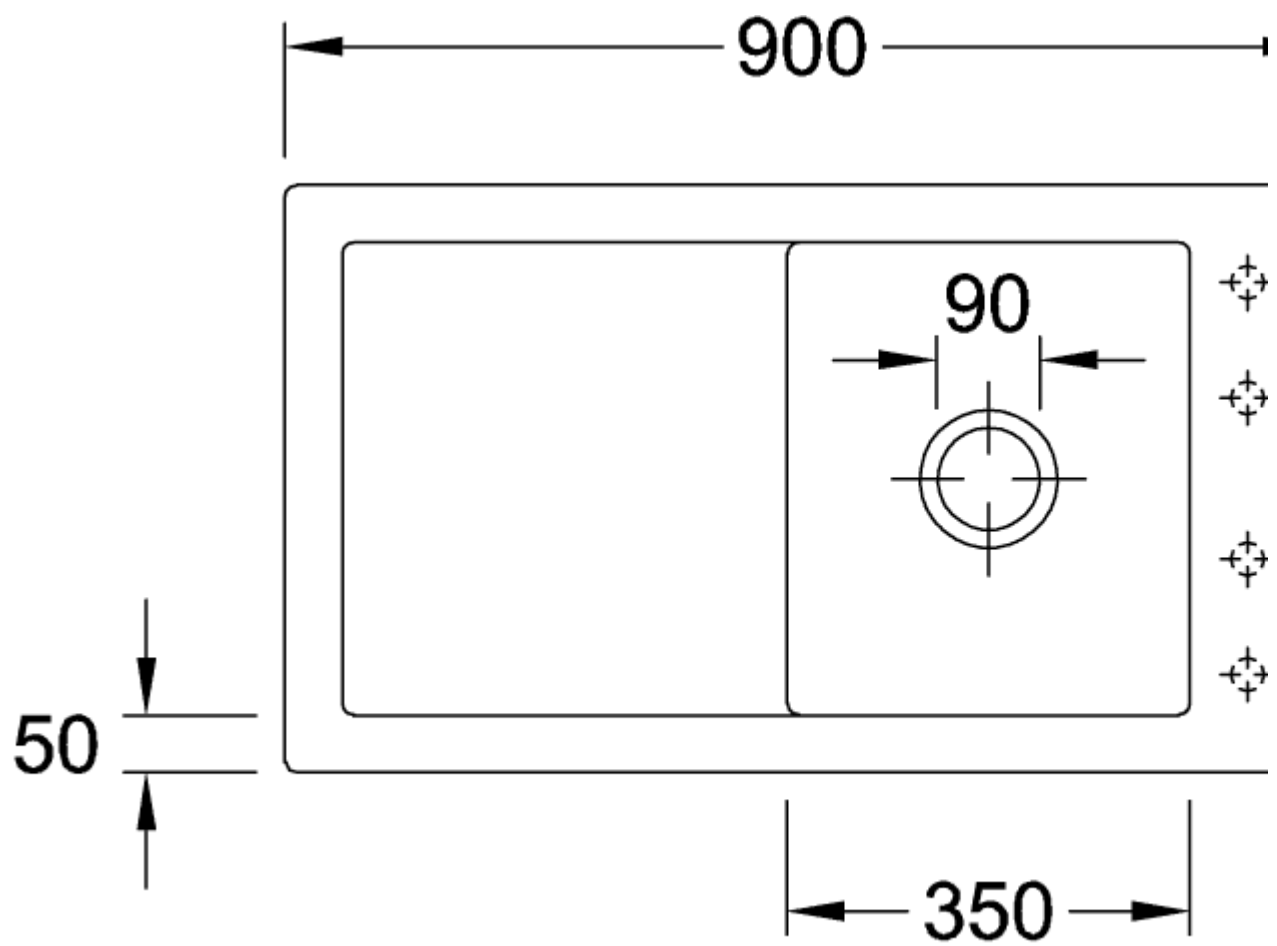

**330701RW**

